



MILEO



CREATED FOR ADVENTURE



2025 SEASON PRICE LIST

PRICES AND SPECIFICATION EFFECTIVE 1ST OCTOBER 2024

MILEO 243

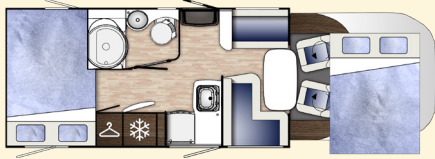

4 BELTS 4 BERTHS ISOFIX

| | | |
|--------------------------------|-----------------|-------------|
| OVERALL LENGTH | 6990mm 22'11" | |
| OVERALL WIDTH (MIRRORS FOLDED) | 2300mm 7'6" | |
| OVERALL HEIGHT (EXC TV AERIAL) | 2890mm 9'5" | |
| MTPLM | 140BHP MANUAL | 180BHP AUTO |
| | 3650kg | 4400kg |
| MAX USER PAYLOAD | 501kg | 1251kg |

FIAT DUCATO 140BHP MANUAL ENGINE

£79,995 OTR

FIAT DUCATO 180BHP AUTOMATIC ENGINE

£87,995 OTR

MILEO 286

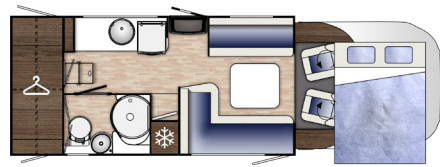

4 BELTS 4 BERTHS ISOFIX

| | | |
|--------------------------------|----------------|-------------|
| OVERALL LENGTH | 6950mm 22'8" | |
| OVERALL WIDTH (MIRRORS FOLDED) | 2300mm 7'6" | |
| OVERALL HEIGHT (EXC TV AERIAL) | 2890mm 9'5" | |
| MTPLM | 140BHP MANUAL | 180BHP AUTO |
| | 3650kg | 4400kg |
| MAX USER PAYLOAD | 519kg | 1269kg |

FIAT DUCATO 140BHP MANUAL ENGINE

£79,995 OTR

FIAT DUCATO 180BHP AUTOMATIC ENGINE

£87,995 OTR

MILEO 282

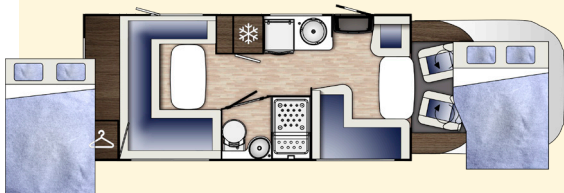

4 BELTS 4 BERTHS ISOFIX

| | | |
|--------------------------------|----------------|-------------|
| OVERALL LENGTH | 7390mm 24'2" | |
| OVERALL WIDTH (MIRRORS FOLDED) | 2300mm 7'6" | |
| OVERALL HEIGHT (EXC TV AERIAL) | 2890mm 9'5" | |
| MTPLM | 140BHP MANUAL | 180BHP AUTO |
| | 3650kg | 4400kg |
| MAX USER PAYLOAD | 434kg | 1184kg |

FIAT DUCATO 140BHP MANUAL ENGINE

£81,995 OTR

FIAT DUCATO 180BHP AUTOMATIC ENGINE

£89,995 OTR

MILEO 294

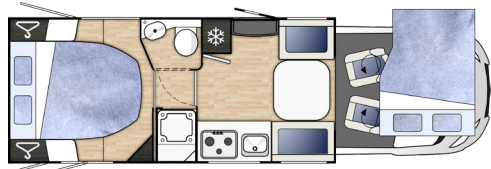

4 BELTS 4 BERTHS ISOFIX

| | | |
|--------------------------------|----------------|-------------|
| OVERALL LENGTH | 7390mm 24'2" | |
| OVERALL WIDTH (MIRRORS FOLDED) | 2300mm 7'6" | |
| OVERALL HEIGHT (EXC TV AERIAL) | 2890mm 9'5" | |
| MTPLM | 140BHP MANUAL | 180BHP AUTO |
| | 3650kg | 4400kg |
| MAX USER PAYLOAD | 400kg | 1146kg |

FIAT DUCATO 140BHP MANUAL ENGINE

£81,995 OTR

FIAT DUCATO 180BHP AUTOMATIC ENGINE

£89,995 OTR

OPTIONAL EXTRAS

PARADORE UPHOLSTERY IN LIEU OF STANDARD **£995**



YOUR LOCAL BENIMAR MILEO DEALER

Camps Industrial Estate | East Calder | Livingston | Scotland | EH27 8DF

T: 01506 880 411

www.caldercampers.co.uk



IMPORTANT INFORMATION The contents of this publication are as accurate as possible at the time of going to press (January 2025), but this information should not be regarded as an infallible guide to current specifications, nor does it constitute an offer for the sale of any particular vehicle. Prices effective 1st October 2024. The base price is for the vehicle with its standard specification. The On the Road (OTR) price includes the cost of Number Plates, all delivery charges, First Year VED (Road Tax) and 1st Registration Fee (as set by H.M Government) at point of registration. VAT inclusive at 20%. This price list supersedes all others.